

# Installation Instructions for External-Mounted Type C-Cast Joints

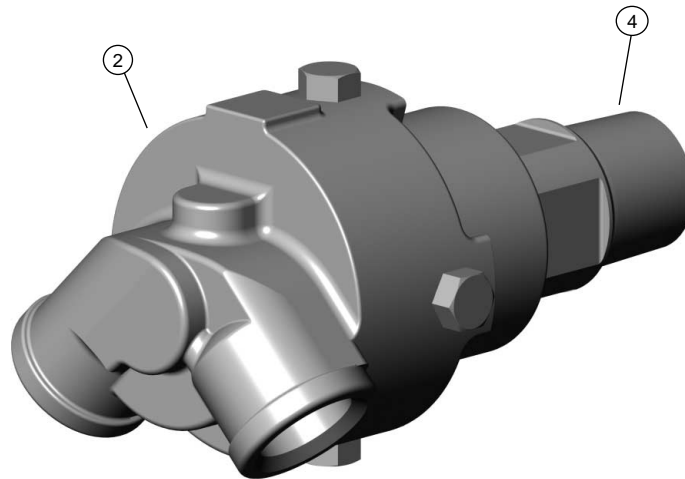

## Type CJED

**NOTE:** Please follow your company's safety procedures whenever working on Kadant Johnson rotary joints and read all of the instructions completely before proceeding.

Please refer to the assembly drawing supplied with your Kadant Johnson rotary joint for part identification. If you have any further questions, please contact your Representative or Kadant Johnson.

### Single Flow (CJEA) No Supply Pipe

Attach joint to the journal as described in **Mounting to Journal** for your nipple design.

### Dual Flow (CJED) Stationary Supply Pipe

First thread the supply pipe into the rotary joint head (2) and then attach joint to the journal as described in **Mounting to Journal**.

## Mounting to Journal

**Threaded Nipple:** Thread nipple (4) into journal properly sealing it using the required sealant for your nipple: Pipe Sealant (tapered threads); Copper Gasket (straight threads).

**Quick Release Nipple:** Place copper gasket into journal flange; Place nipple flange and split wedges on 'Q' nipple (4); Tighten bolts evenly on nipple flange so that the space between flanges is even.

## Installation Notes

1. Supply pipe can be guided to the head (2) while looking through the P connection.
2. Attention should be given to length of supply pipe. Excess length can cause flow to be cut off against interior of head (2).

## Flexible Hose Connection

When connecting the rotary joint to the fixed piping the flexible hose should be installed as close to the joint as possible, in a relaxed condition, neither stretched or compressed. If you have an unusually long run of hose, it is suggested that you support the hose so as not to overload the internal bearing of the rotary joint.

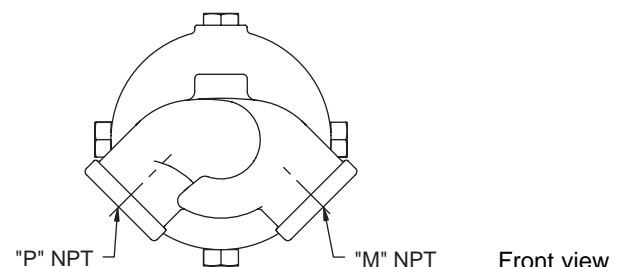

### The Kadant Johnson Warranty

Kadant Johnson products are built to a high standard of quality. Performance is what you desire: that is what we provide. Kadant Johnson products are warranted against defects in materials and workmanship for a period of one year after date of shipment. It is expressly understood and agreed that the limit of Kadant Johnson's liability shall, at Kadant Johnson's sole option, be the repair or resupply of a like quantity of non-defective product.

**KADANT**  
JOHNSON

www.kadantjohnson.com